



Devan Pump Stations

750L to 10,000L

Product Selection Guide



DEVAN 750L STANDARD PUMP STATION	1
DEVAN 750L MACERATING PUMP STATION	2
DEVAN 850L STANDARD PUMP STATION	3
DEVAN 850L MACERATING PUMP STATION	4
DEVAN 2,100L STANDARD PUMP STATION	5
DEVAN 2,100L MACERATING PUMP STATION	6
DEVAN 3,600L STANDARD PUMP STATION	7
DEVAN 3,600L MACERATING PUMP STATION	8
DEVAN 2,000L TO 10,000L CUSTOM PUMP STATION	9
N2P CONTROLS PUMP STATION CONTROLLER SPEC	10
BIANCO SUBMERSIBLE PUMP BIA-B42A SPEC	11
BIBIANCO SUBMERSIBLE GRINDER PUMP BIA-B120GS2 SPEC	12
PUMP SELECTION QUESTIONNAIRE	13

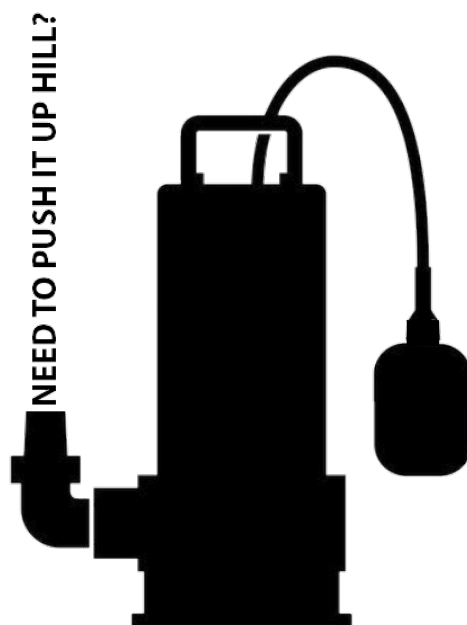

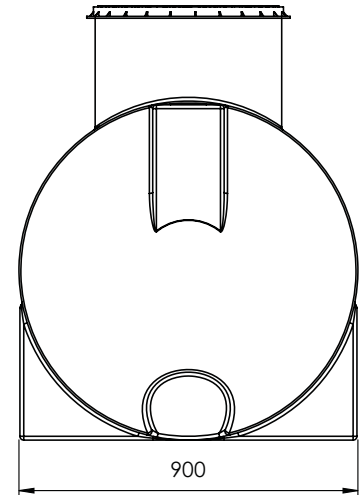
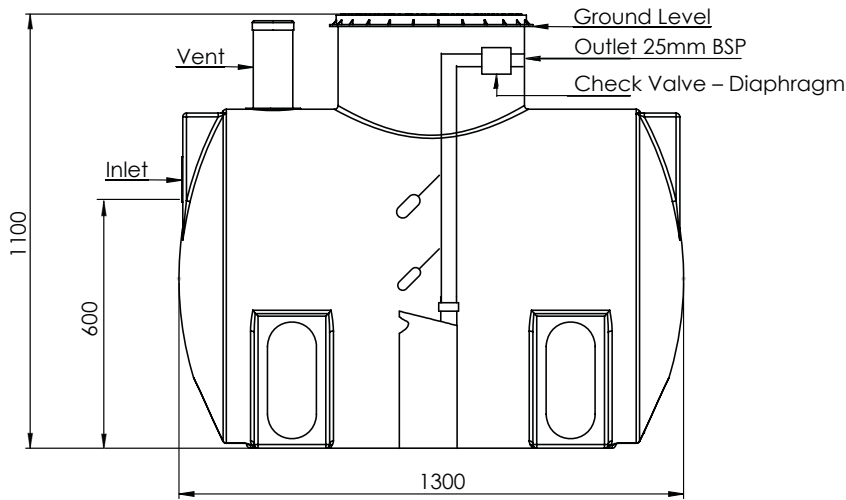

Application and Use

For efficient pumping of primary treated domestic wastewater or stormwater, suitable for pumping to council gravity sewer lines or when fall is not available on site.

Specifications

Code: DW750P
 Max. Vol: 750L
 Voltage: 240 V/50Hz
 Pump: Bianco B-42A - 0.55kW
 Discharge: 25mm BSP
 Max Head: 30m
 Flow: 2.1m³/h @ 20m Head
 Alarms: High Level with mute reset
 Effluent quality: No change in state
 Conforming Standards: AS/NZS3500.2.2018 Section 12.8*

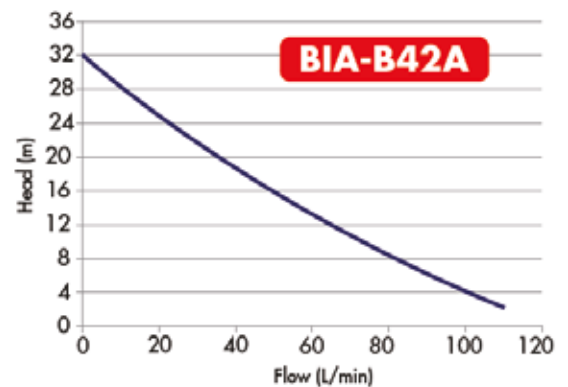

* compliance to AS/NZS3500.2.2018 Section 12.8 requires the supply installation of an isolation valve and minimum DN50 vent fitted by others

Features and Benefits

- Light weight modular system
- Simple proven technology
- Low power consumption

Maintenance

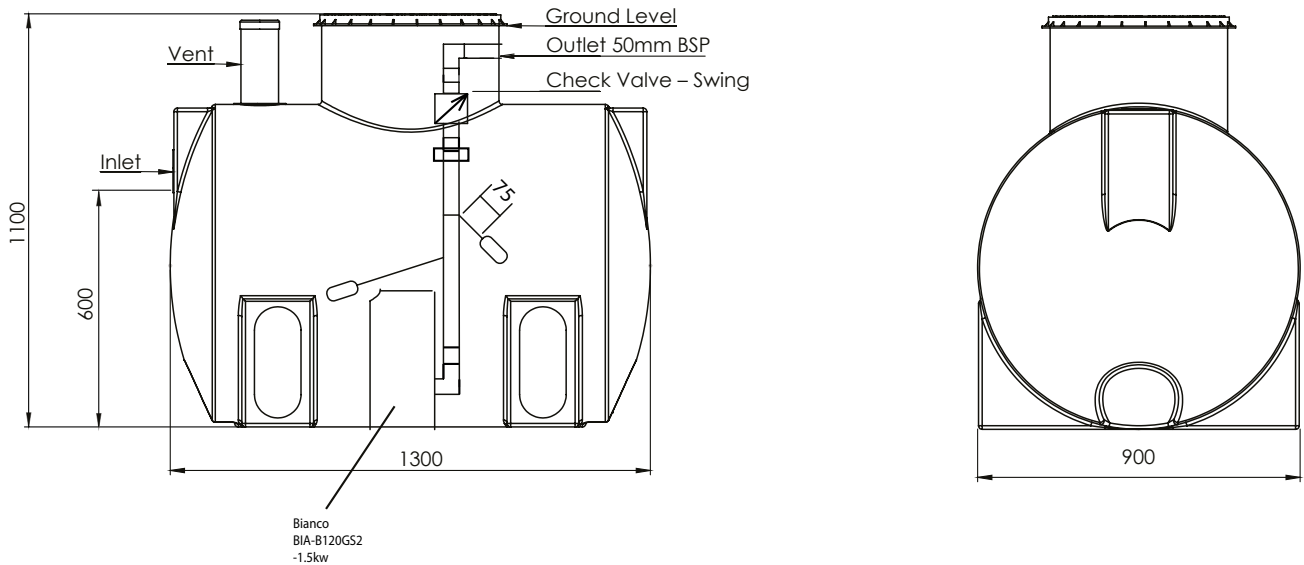

Application and Use

For efficient pumping of domestic wastewater suitable for pumping to council sewer lines when fall is not available on site.

Specifications

Code: DW750PMAS
 Max. Vol 750L
 Voltage: 240 V/50Hz
 Pump: Bianco BIA-B120GS2 - 1.5kW
 Discharge: 50mm BSP
 Max Head: 16m
 Flow: 12.5m³/h @ 8m Head
 Alarms: High Level with mute reset
 Effluent quality: Macerated untreated sewage
 Conforming Standards: AS/NZS3500.2.2018 Section 12.8*

Performance Curve

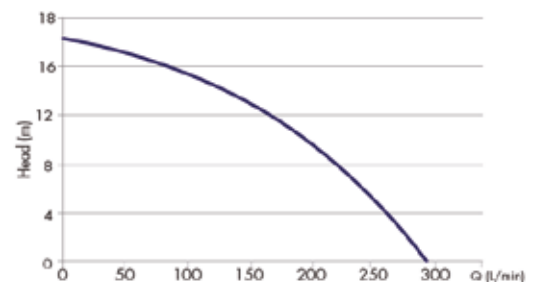

* compliance to AS/NZS3500.2.2018 Section 12.8 requires the supply installation of an isolation valve and minimum DN50 vent fitted by others

Features and Benefits

- Light weight modular system
- Simple proven technology

Maintenance

Maintenance requirements are as per your local authority or as required pump servicing, grinder replacement and high level alarm testing.

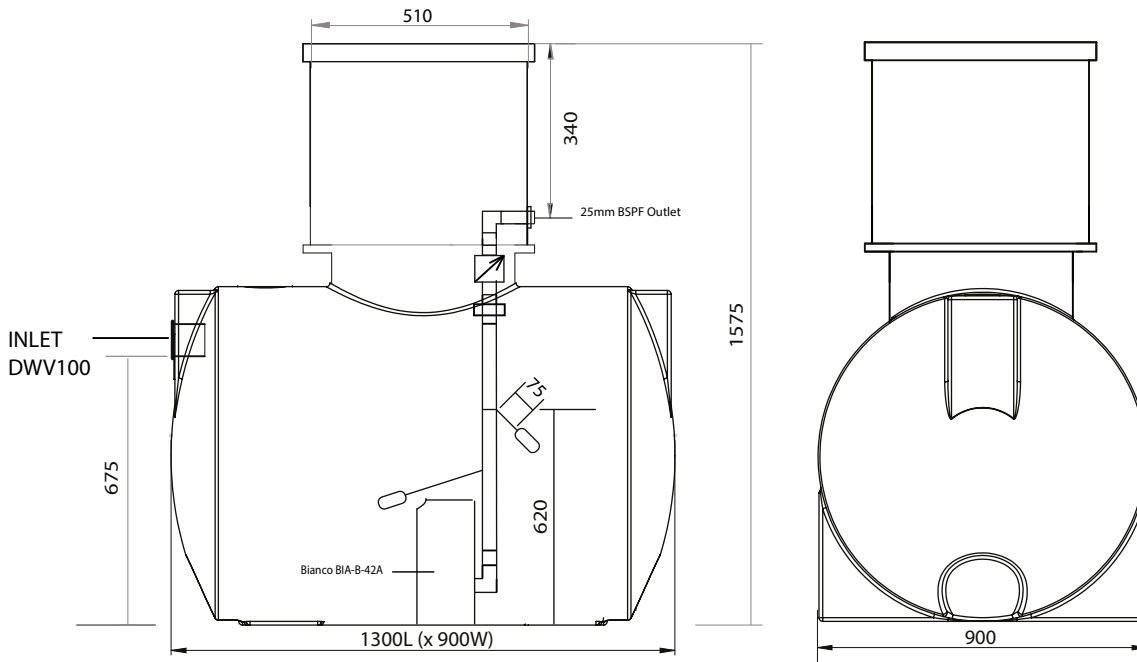

Application and Use

For efficient pumping of primary treated domestic wastewater or stormwater, suitable for pumping to council gravity sewer lines or when fall is not available on site.

Specifications

Code: DW750P
 Max. Vol: 850L
 Voltage: 240 V/50Hz
 Pump: Bianco B-42A - 0.55kW
 Discharge: 25mm BSP
 Max Head: 30m
 Flow: 2.1m³/h @ 20m Head
 Alarms: High Level with mute reset
 Effluent quality: No change in state
 Conforming Standards: AS/NZS3500.2.2018 Section 12.8*

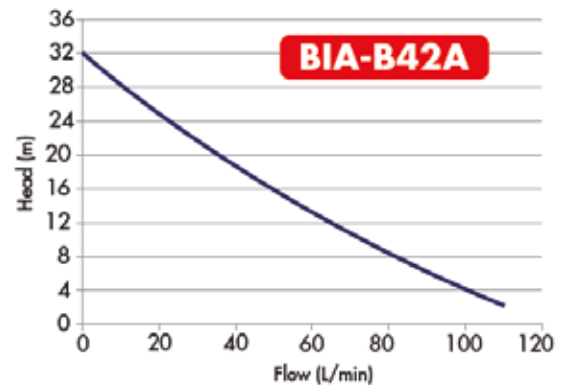

* compliance to AS/NZS3500.2.2018 Section 12.8 requires the supply installation of an isolation valve and minimum DN50 vent fitted by others

Features and Benefits

- Light weight modular system
- Simple proven technology
- Low power consumption

Maintenance

Maintenance requirements are as per your local authority or as required pump servicing, and high level alarm testing.

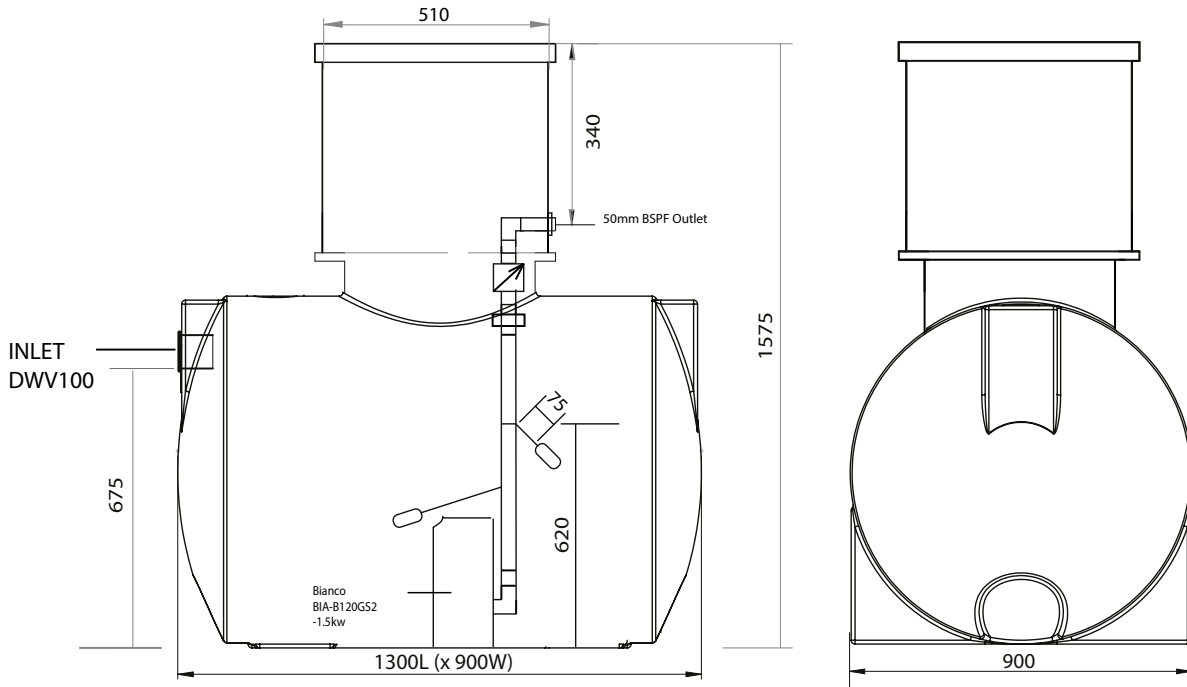

Application and Use

For efficient pumping of domestic wastewater suitable for pumping to council sewer lines when fall is not available on site.

Specifications

Code: DW850PMAS
 Max. Vol: 850L
 Voltage: 240 V/50Hz
 Pump: Bianco BIA-B120GS2 - 1.5kW
 Discharge: 50mm BSP
 Max Head: 16m
 Flow: 12.5m³/h @ 8m Head
 Alarms: High Level with mute reset
 Effluent quality: Macerated untreated sewage
 Conforming Standards: AS/NZS3500.2.2018 Section 12.8*

Performance Curve

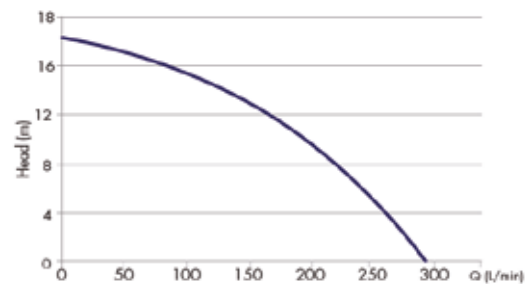

* compliance to AS/NZS3500.2.2018 Section 12.8 requires the supply installation of an isolation valve and minimum DN50 vent fitted by others

Features and Benefits

- Light weight modular system
- Simple proven technology

Maintenance

Maintenance requirements are as per your local authority or as required pump servicing, grinder replacement and high level alarm testing.

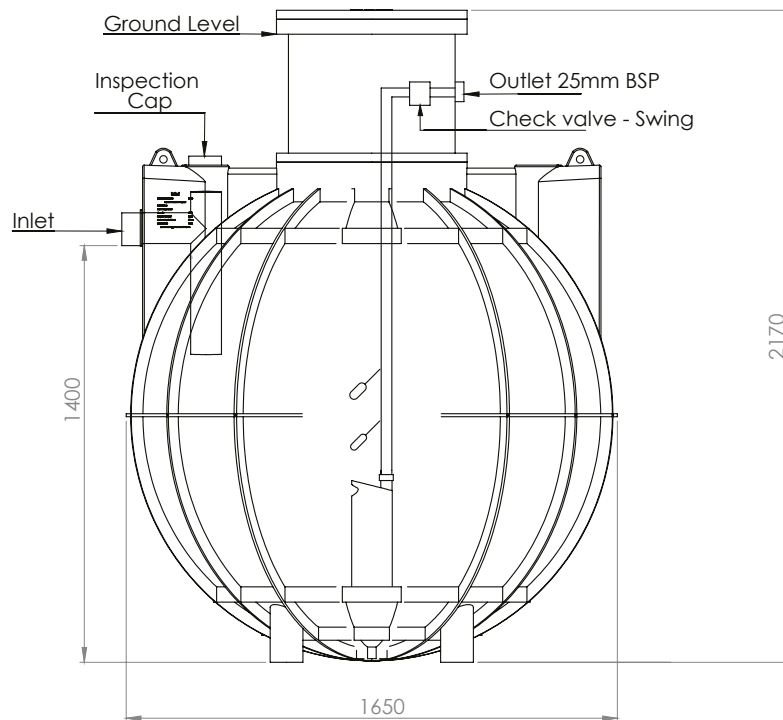

Application and Use

For efficient pumping of primary treated domestic wastewater or stormwater, suitable for pumping to council gravity sewer lines or when fall is not available on site.

Specifications

Code: DW2100P
 Max. Vol: 2100L
 Voltage: 240 V/50Hz
 Pump: Bianco B-42A - 0.55kW
 Discharge: 25mm BSP
 Max Head: 30m
 Flow: 2.1m³/h @ 20m Head
 Alarms: High Level with mute reset
 Effluent quality: No change in state
 Conforming Standards: AS/NZS1546.1:2008, AS/NZS3500.2.2018 Section 12.8*

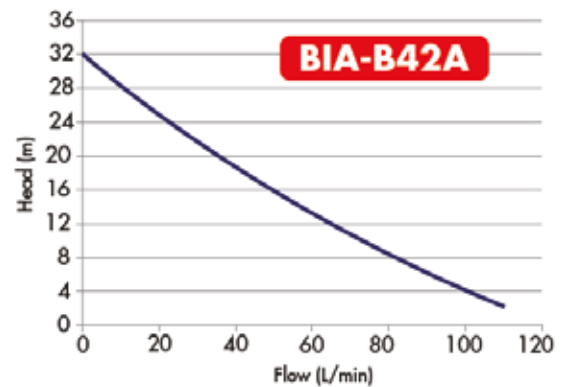

* compliance to AS/NZS3500.2.2018 Section 12.8 requires the supply installation of an isolation valve and minimum DN50 vent fitted by others

Features and Benefits

- Light weight modular system
- Simple proven technology
- Low power consumption

Maintenance

Maintenance requirements are as per your local authority or as required pump servicing, and high level alarm testing.

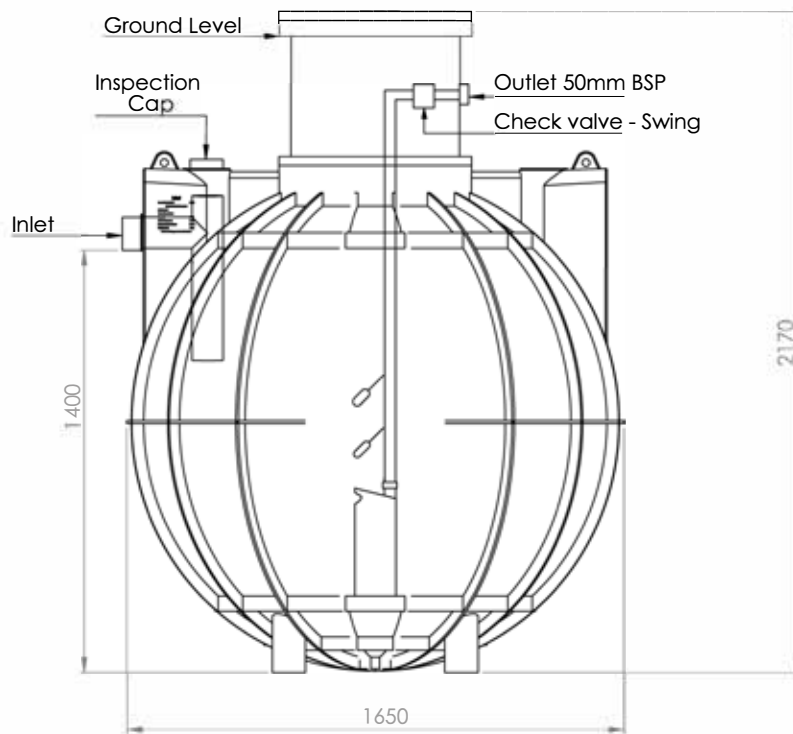

Application and Use

For efficient pumping of domestic wastewater suitable for pumping to council sewer lines when fall is not available on site.

Specifications

Code: DW210PMAS
 Max. Vol: 2,100L
 Voltage: 240 V/50Hz
 Pump: Bianco BIA-B120GS2 - 1.5kW
 Discharge: 50mm BSP
 Max Head: 16m
 Flow: 12.5m³/h @ 8m Head
 Alarms: High Level with mute reset
 Effluent quality: Macerated untreated sewage
 Conforming Standards: AS/NZS1546.1:2008, AS/NZS3500.2.2018 Section 12.8*

Performance Curve

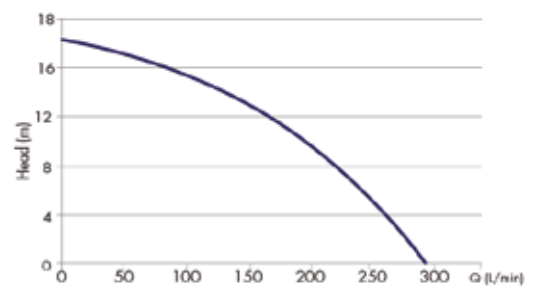

* compliance to AS/NZS3500.2.2018 Section 12.8 requires the supply installation of an isolation valve and minimum DN50 vent fitted by others

Features and Benefits

- Light weight modular system
- Simple proven technology

Maintenance

Maintenance requirements are as per your local authority or as required pump servicing, grinder replacement and high level alarm testing.

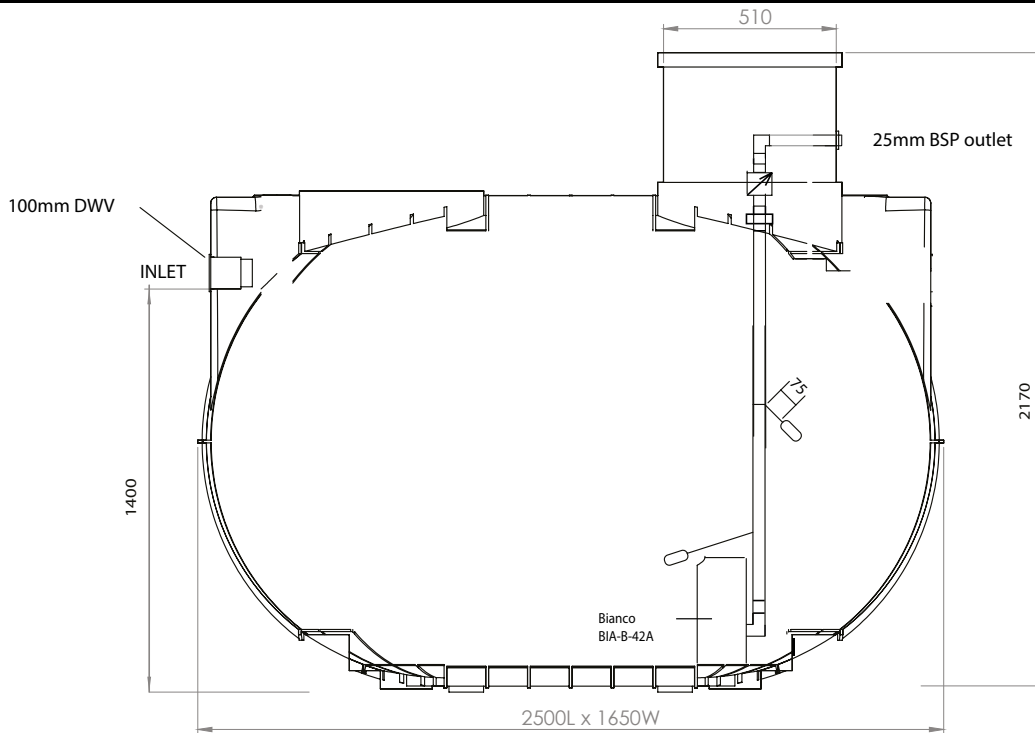

Application and Use

For efficient pumping of primary treated domestic wastewater or stormwater, suitable for pumping to council gravity sewer lines or when fall is not available on site.

Specifications

Code: DW3600P
 Max. Vol: 3600L
 Voltage: 240 V/50Hz
 Pump: Bianco B-42A - 0.55kW
 Discharge: 25mm BSP
 Max Head: 30m
 Flow: 2.1m³/h @ 20m Head
 Alarms: High Level with mute reset
 Effluent quality: No change in state
 Conforming Standards: AS/NZS1546.1:2008, AS/NZS3500.2.2018 Section 12.8*

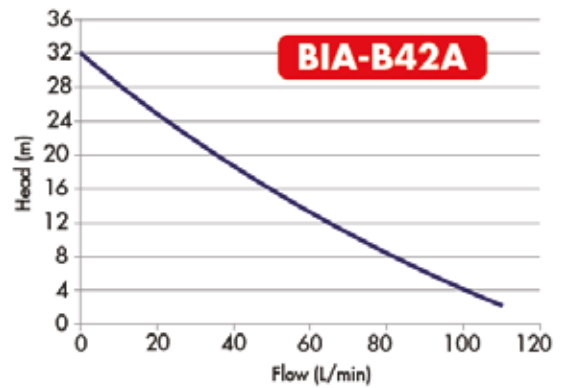

* compliance to AS/NZS3500.2.2018 Section 12.8 requires the supply installation of an isolation valve and minimum DN50 vent fitted by others

Features and Benefits

- Light weight modular system
- Simple proven technology
- Low power consumption

Maintenance

Maintenance requirements are as per your local authority or as required pump servicing, and high level alarm testing.

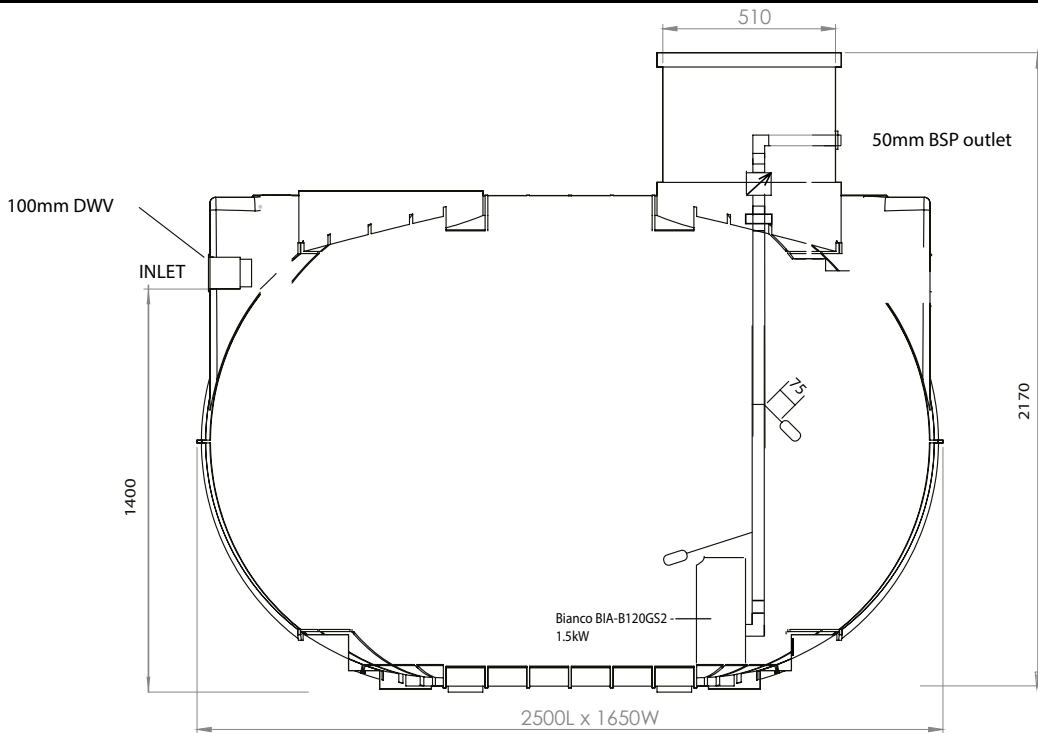

Application and Use

For efficient pumping of domestic wastewater suitable for pumping to council sewer lines when fall is not available on site.

Specifications

Code: DW210PMAS
 Max. Vol: 2,100L
 Voltage: 240 V/50Hz
 Pump: Bianco BIA-B120GS2 - 1.5kW
 Discharge: 50mm BSP
 Max Head: 16m
 Flow: 12.5m³/h @ 8m Head
 Alarms: High Level with mute reset
 Effluent quality: Macerated untreated sewage
 Conforming Standards: AS/NZS1546.1:2008, AS/NZS3500.2.2018 Section 12.8*

Performance Curve

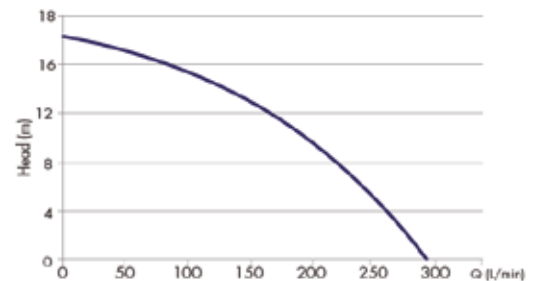

* compliance to AS/NZS3500.2.2018 Section 12.8 requires the supply installation of an isolation valve and minimum DN50 vent fitted by others

Features and Benefits

- Light weight modular system
- Simple proven technology

Maintenance

Maintenance requirements are as per your local authority or as required pump servicing, grinder replacement and high level alarm testing.

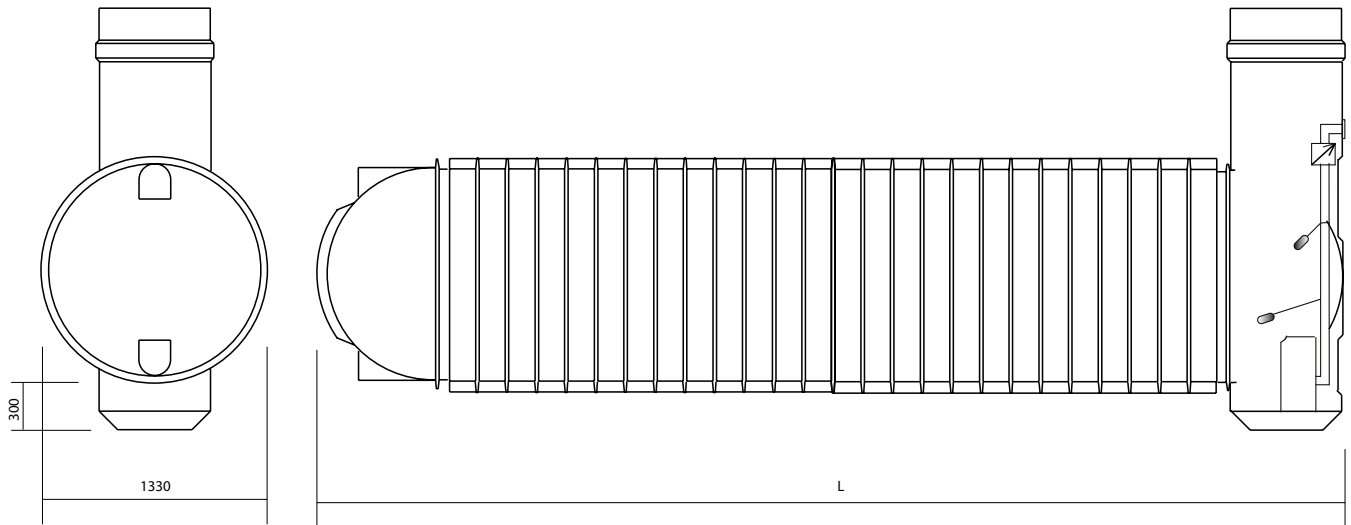

Code	Tank Volume L	L (m)
SVP12-02	2,000L	2.3
SVP12-03	3,000L	3.2
SVP12-04	4,000L	4.1
SVP12-05	5,000L	5.0
SVP12-06	6,000L	5.9
SVP12-07	7,000L	6.7
SVP12-08	8,000L	7.7
SVP12-09	9,000L	8.6
SVP12-10	10,000L	9.5

Code	Lid Type
SVALP	Plastic lid
SVALTC	Cast Iron Lid class D - Commercial trafficable
SVALAR	Adaptor ring and temporary lid

Code	Other
SVGA-12	Ground anchor set - 1200mm

Application and Use

Fully customisable volumes from 2,000L to 10,000L for efficient pumping of domestic wastewater suitable for pumping to council sewer lines when fall is not available on site.

Each tank is fully customisable and pump selection is customised to your requirements.

Features and Benefits

- Light weight system
- Can be installed under a concrete drive
- Customer can specify pump
- Easy to install Inlet
- Alarms: High Level with mute reset
- Conforming Standards: AS/NZS3500.2.2018 Section 12.8*

* compliance to AS/NZS3500.2.2018 Section 12.8 requires the supply installation of an isolation valve and minimum DN50 vent fitted by others

Maintenance

Maintenance requirements are as per your local authority or as required pump servicing, grinder replacement and high level alarm testing.



Application and Use

N2P Controls advanced pump controller is a simple and robust unit that takes care of your pump stations need

Features and Benefits

- High level alarm with warning light and buzzer
- Pump fault alarm with warning light and buzzer
- Mute button to silent alarm for 24 hours
- Installation completed by registered electrician
- Adjustable pump overload set points (carried out by installing electrician)

Maintenance

Maintenance requirements are as per your local authority or as required

BIANCO PUMPZ



Submersible high head pump designed for AWTS and rainwater tanks. Fitted with noryl impellers and stainless steel strainer. AS/NZS4020 Approved for drinking water, 5 star energy rating, 550 watts.

Features

- Glass Filled Nylon pump body and Stainless Steel cover for strength and lightness.
- Easy grip, nylon carry handle.
- Dual mechanical seals (Carbon ceramic on pump side / silicon carbide in oil bath on motor side).
- 3 Stage High Head pump with durable Noryl impellers.
- Elevated (83mm) suction intake with Algae-Proof slotted strainer.
- 10m Power lead and automatic Float Switch. All cables to H07RNF standard.
- 240V Single Phase , 0.55kW 5 Star efficient motor. Built in auto-resetting thermal overloads
- **Benefits**
- Strainer design improves water flow and prevents blockage from algae growth.
- Elevated intake draws oxygenated water from higher in tank and avoids sludge layer.
- Leads to improved water quality with lower algae and anaerobic mater for better smelling water and cleaner clothes washing.
- Quality pump materials assist with longer pump life while still being light to lift and lower.
- High Head pump with low energy usage
- **Applications**
- Domestic pressure systems (with optional Press Control)
- Pumping Clean and pre-treated water.
- AWTS – Automated Water Treatment Systems pump out to dripper beds.
- De-watering of cellars, basements and garages.

Liquid:

Clean water temperature range: 2 – 35 °C

Materials:

Pump body: Glass filled nylon
 Strainer: 304 SS
 Impeller: Glass filled nylon
 Shaft: Stainless Steel 410
 Shaft seal: Dual mechanical seals (Carbon ceramic on pump side and silicon carbide/ceramic in oil bath on motor side)

Installation:

Maximum ambient temperature: 40 °C
 Pipe connections discharge: 1"

Electrical data:

Rated voltage: 240V
 Mains frequency: 50 Hz
 Rated output: 550W
 Current: 4.0 amps
 Capacitor: 20 uF
 Motor duty: Continuous
 Motor type: Asynchronous
 Motor protection: In-built thermal overload
 Ingress protection: IP 68
 Insulation class: F
 Power cable length: 10 m H07RNF
 Net weight: 12 kg
 Dimensions: 171Lx162Wx461H (mm)

2 Year Bianco Pumpz Warranty

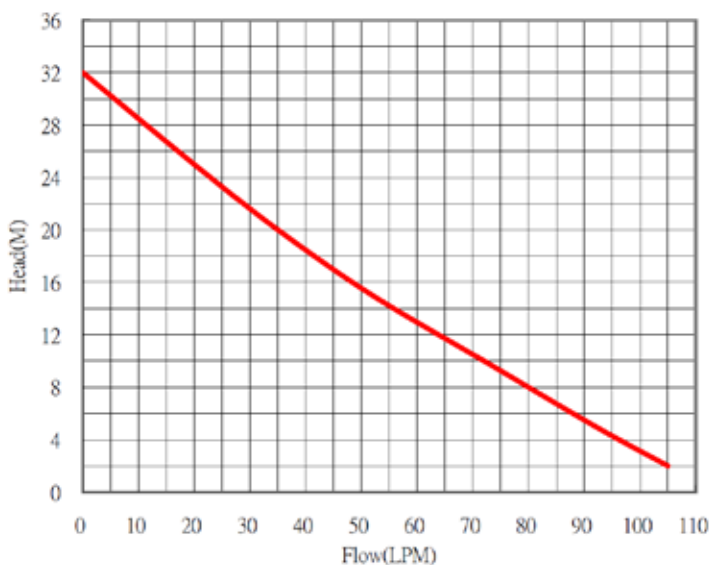



impeller



grinding device

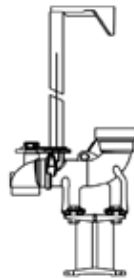

coupling
foot is also
available

The B120GS2 & B120GMS2 is a new generation of hybrid cutter/grinder pump for use in waste water applications containing soft solids. The pump is capable of cutting and grinding various materials for pumping to sewer mains or treatment facility.

The pump is characterised by:

- Cast iron pump body and impeller,
- stainless steel cutting/grinding device and motor shroud

- Available in manual or automatic pump
- Dual Ceramic/graphite mechanical seal
- Convenient carry handle

- 240V single phase motor with built-in auto reset thermal overload

- For use in dewatering effluent and sewage containing soft solids

- Domestic or Industrial sewage

- Flows to **34l** l/min

- Heads to **20m**

Electrical data:

- Rated Voltage: 240V
- Mains Frequency: 50Hz
- Rated output: 1.5kW
- Current: 9.5A
- Capacitor: 30 µF
- Motor Duty: Continuous
- Motor Type: Asynchronous
- Motor protection: Built-in thermal overload
- Ingress protection: IPX8
- Insulation class: B
- Power cable length: 10m H07RNF
- Net weight: 27kg

Liquid:

Clean water temperature range: 40 °C

Materials:

- Pump body: Cast Iron
- Motor shroud: 304 Stainless Steel
- Impeller: Cast Iron
- Motor Shaft: Stainless Steel
- Cutting Device: Stainless Steel
- Shaft seal: Dual mechanical seals (Ceramic/Graphite)

Installation:

Max. Ambient temperature: 40°C

Pipe Connection: 2" F

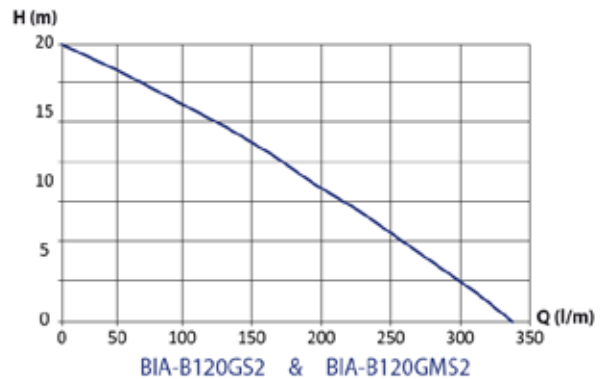

2 Year Bianco Pumpz Warranty



White International NZ Ltd

15G Kerwyn Avenue
Highbrook, East Tamaki
Auckland 2013
New Zealand

Telephone +64 9 579 9777

Facsimile +64 9 579 7775

COMPANY NAME: _____

CONTACT PERSON: _____

EMAIL: _____

PHONE: _____

DATE: _____

QUOTATION # _____

1. Requirement

- Household Pressure Garden Sprinkler(s) Wash Down Drainage
 Tank Filling Irrigation Sewage

2. Water Source

- Dam Bore Spearpoint Tank
 Aboveground Inground River
 Town Mains (if mains are different times of the day, require 3 separate pressure readings)

3. If Pumping from a Bore

Bore Diameter _____ Type of Casing _____
 Fully Cased Yes No Is the casing slotted? Yes No
 Standing Water Level (SWL) _____ metres
 Draw down (at rated flow) DDL _____ metres
 Aquifer Depth _____ metres
 (Indicated depth of other) _____ metres
 Bore Test (six hours min) Yes No
 Rated Flow _____ L/m

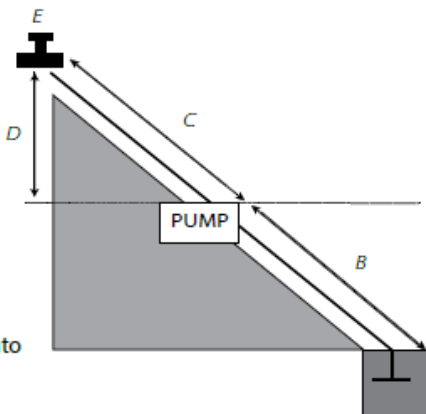

4. Power Supply

If powered by generator please state KVA _____

5. Required to Operate Manual Auto

6. Application

Suction Pipe (if existing)
 A) Height from water to pump _____ metres (allow for drops in water level)
 B) Pipe Length _____ metres Type _____
 Diameter of Pipe _____ mm Class of Pipe _____
 Deliver Pipe (if existing)
 C) Pipe Length _____ metres Type _____
 Diameter of Pipe _____ mm Class of Pipe _____
 D) Height from pump to discharge _____ metres
 E) Demand Pressure _____ kpa
 F) Demand Flow _____ L/m

What do they want it for? Where does the water come from? Single Phase or Three Phase? Pressure Switch, Pressure Control or VSD?

SUCTION

Open Tank

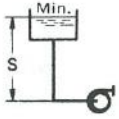

Closed Storage Vessel

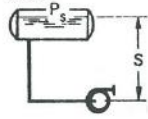

Supply Main

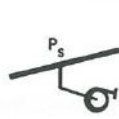

Well, Sump

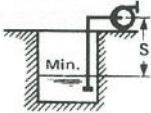

Reservoir, Irrigation Channel

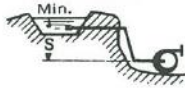

River, Creek, Dam

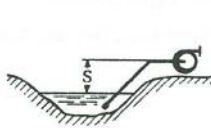

DISCHARGE

Storage Tank

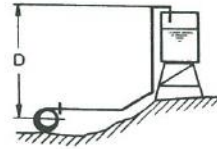

Closed Storage Vessel

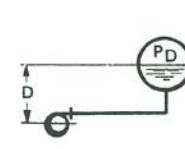

Spray Irrigation

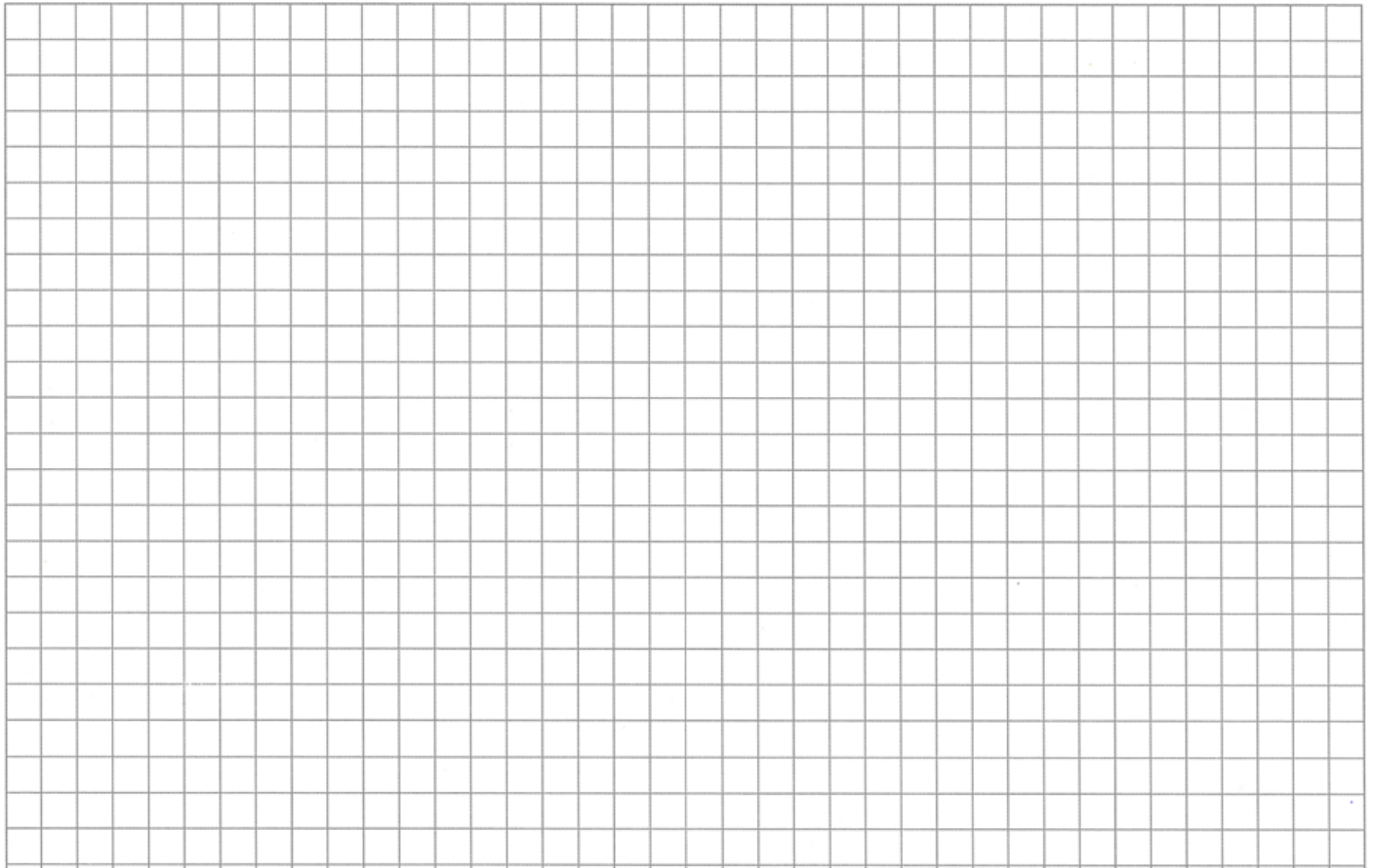
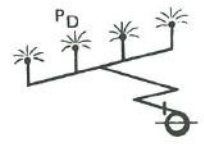

ADDITIONAL INFORMATION:
